



Santa Cruz County
 Department of Public Works
 701 Ocean St., Rm. 410
 Santa Cruz, CA 95060-4000
 Phone: (831) 454-2160
 Fax: (831) 454-2385

PLANTING DETAILS
 EAST CLIFF DRIVE PARKWAY PROJECT
 32nd AVENUE TO 41st AVENUE
 County of Santa Cruz, California

REV	BY	DATE	DESCRIPTION
1		03/22/10	75% SUBMITTAL
2		10/08/10	95% SUBMITTAL
3		01/12/11	BID SET

DATE: 01/12/2011
 SCALE: AS NOTED
 DESIGNED BY: JLJ
 DRAFTED BY: ED/MO
 CHECKED BY: JLJ
 JOB NO.: 08-150
 FILE: 11 EAST CLIFF PARKWAY PLANTING DETAILS.rvt

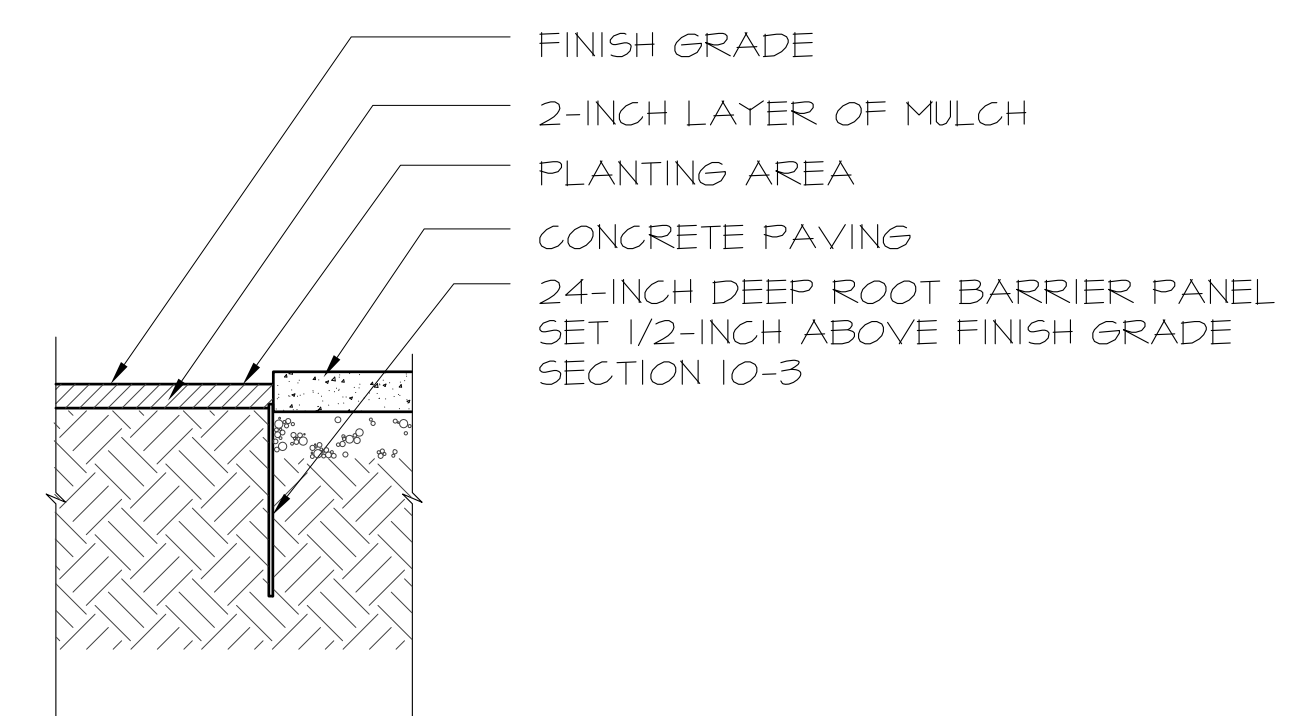

5 ROOT BARRIER DETAIL
NTS

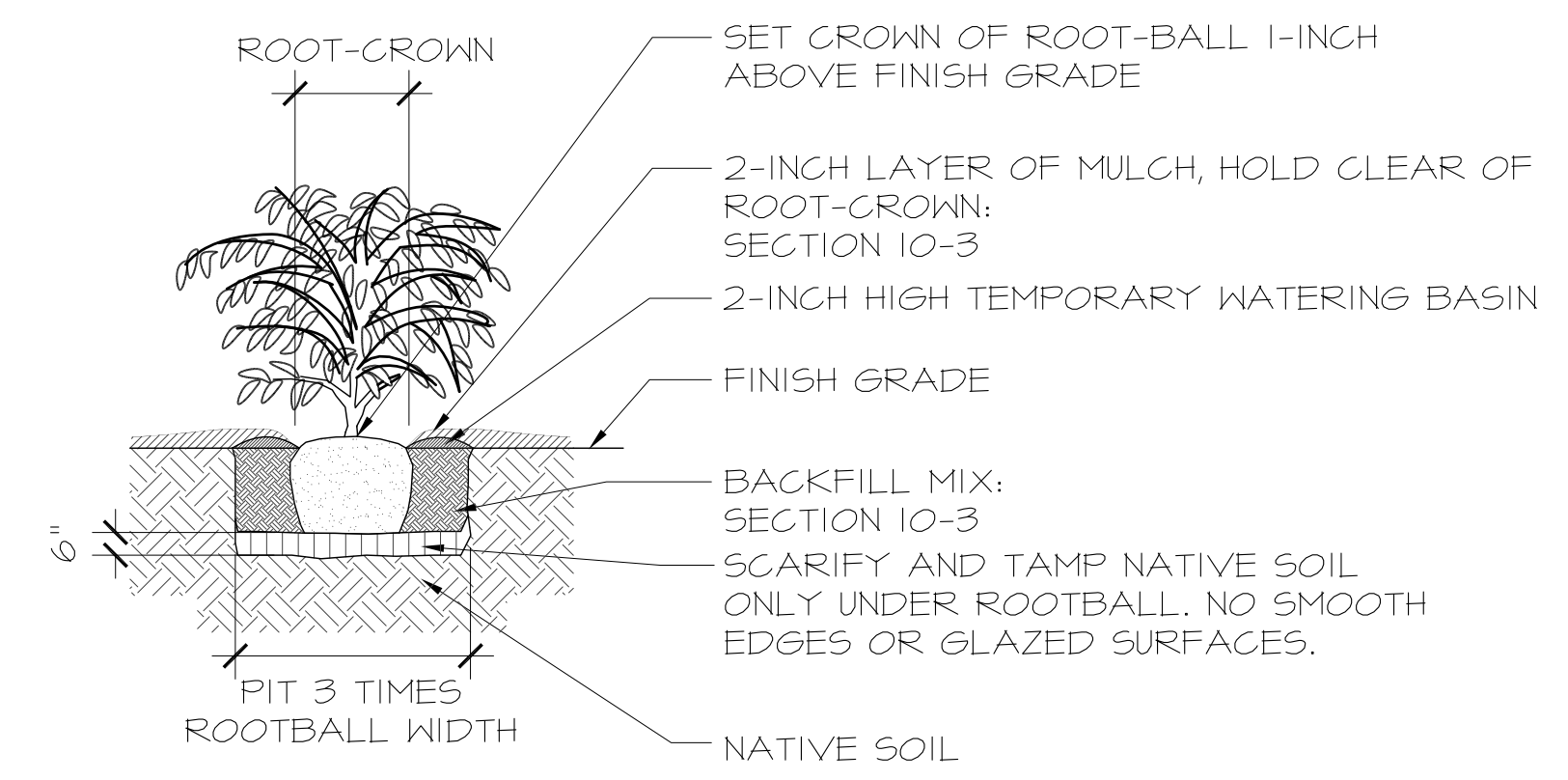

2 SHRUB PLANTING DETAIL
NTS

NOTE:
 1. CONTRACTOR TO PROVIDE WIND BARRIER FABRIC AS NEEDED TO PROTECT SHRUBS DURING ESTABLISHMENT.

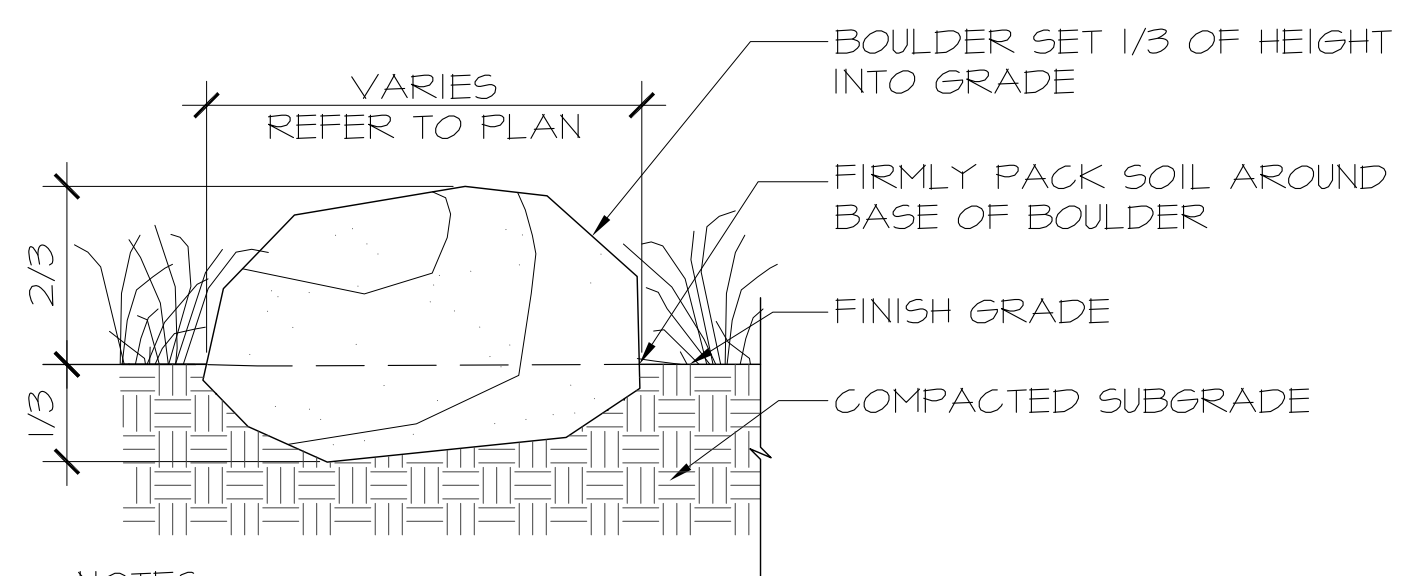

4 BOULDER SETTING DETAIL IN PLANTING
NTS

NOTES:
 1. SEE DRAWING FOR LOCATIONS. SOME LOCATIONS MAY BE LOCATED IN PLANTING AND PAVING AREAS. USE SIMILAR DETAIL.
 2. AVOID CHIPPING OR SCRATCHING BOULDER WHILE MOVING OR STORING.
 3. BOULDERS ARE STORED IN COUNTY CORPORATION YARD LOCATED AT: 2700 BROMMER STREET, SANTA CRUZ, CA 95062
 4. BOULDER DIMENSIONS AND LOCATIONS TO BE DETERMINED.

NOTES:
 1. IN PLANTING IN WINTER MONTHS, CONTRACTOR TO PROVIDE BURLAP FABRIC WIND BARRIER ON WINDWARD SIDES OF TREE. STAPLE TO FASTEN BURLAP TO STAKES AND FULLY SECURE IN PLACE.
 2. CONTRACTOR SHALL STAKE ALL 15 GALLON TREES AS SHOWN.
 3. CONTRACTOR SHALL REMOVE NURSERY STAKE(S) AND TAGS FROM TREES UPON COMPLETION OF STAKING.
 4. "WONDER TREE TIES" SHALL BE INSTALLED PER MANUFACTURER'S INSTRUCTIONS.
 5. REMOVE TEMPORARY WATERING BASINS ONCE RAINY SEASON HAS COMMENCED.

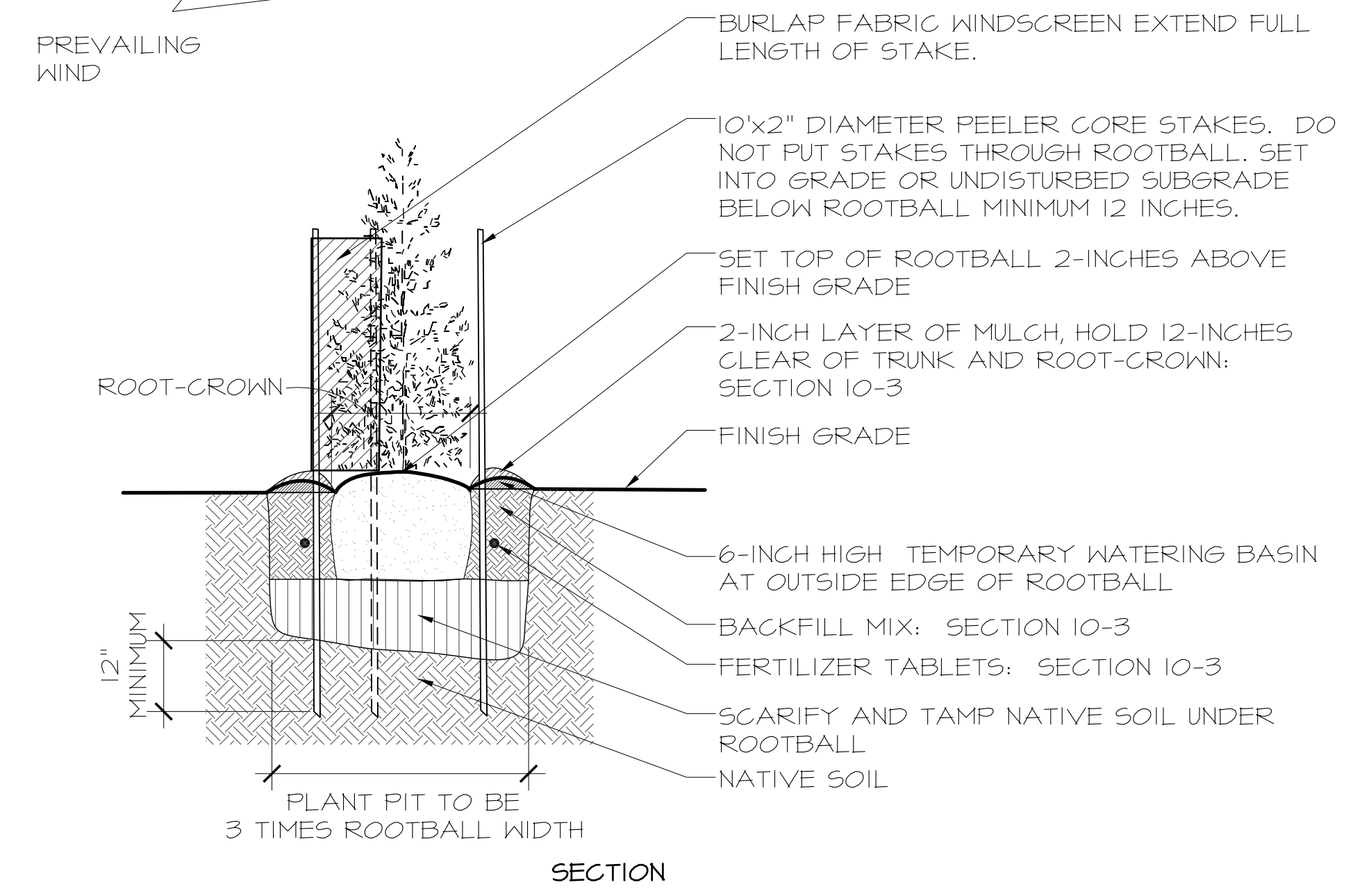
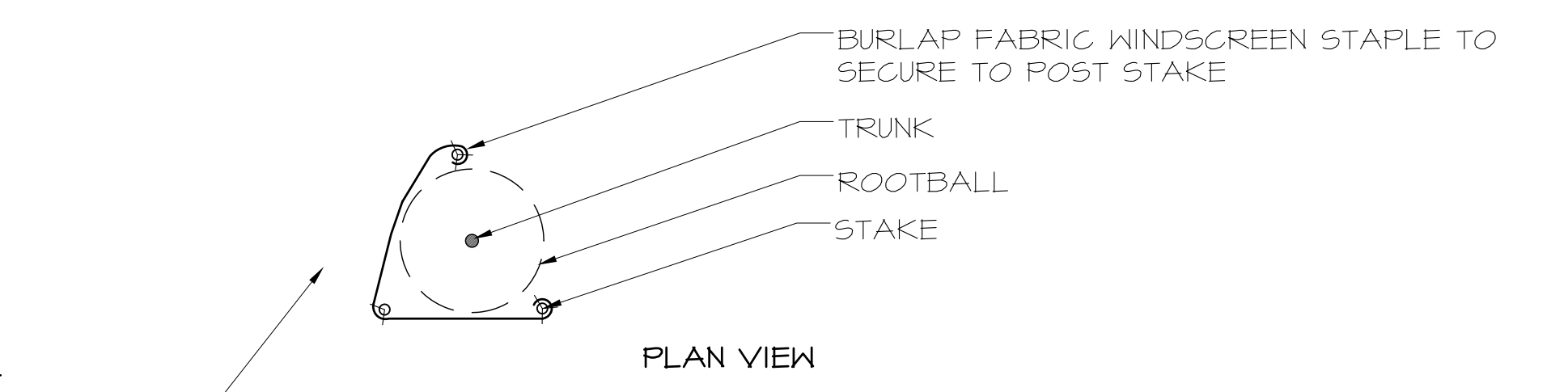

1 TREE PLANTING AND STAKING DETAIL
NTS

NOTE: ORIGINAL SHEET SIZE IS 24X36.

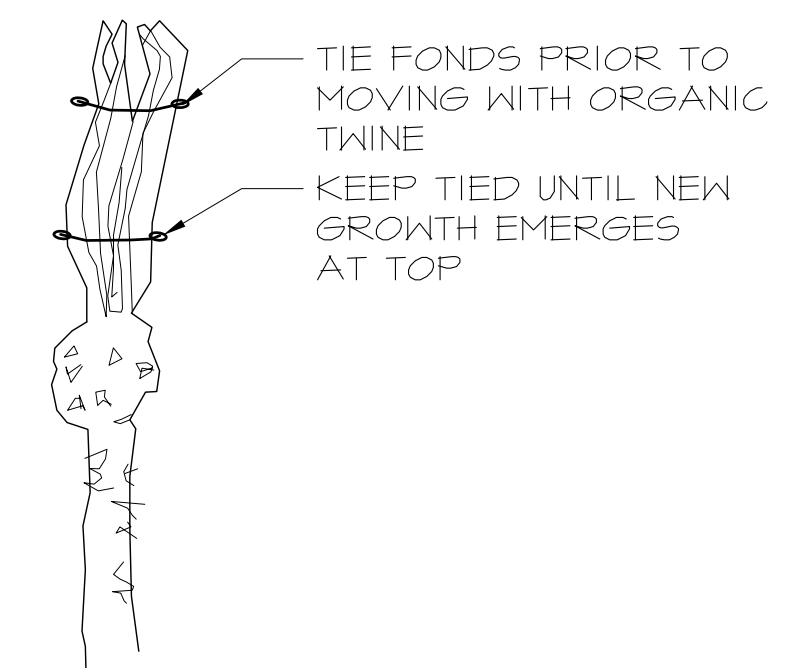

FROND TIE DETAIL

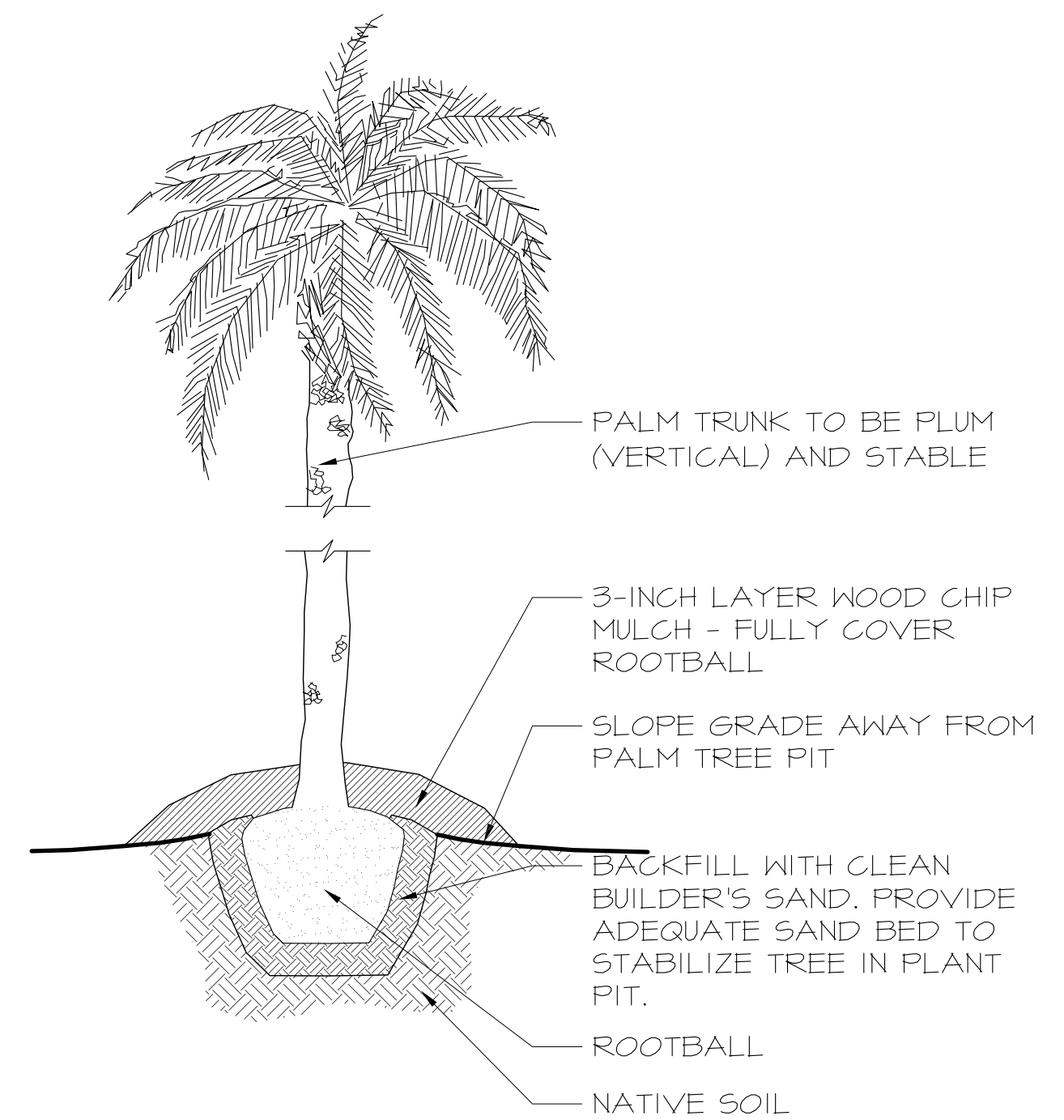

6 TEMPORARY PALM TREE PLANTING DETAIL
NTS

NOTES:
 1. THREE PALM TREES TO BE RELOCATED FROM LOCATION SHOWN ON SHEET C1.0 TO FLORAL PARK ON 38TH AVENUE ONE BLOCK NORTH OF EAST CLIFF DRIVE. THE PRECISE LOCATION WILL BE DETERMINED IN THE ON-SITE IN THE FIELD BY THE OWNER AND LANDSCAPE ARCHITECT. TREE SIZES INCLUDE:
 IIA - 23', CLEAR TRUNK HEIGHT
 IIB - 20', CLEAR TRUNK HEIGHT
 IIC - 42', CLEAR TRUNK HEIGHT
 2. CLEAR TRUNK HEIGHTS ARE APPROXIMATE MEASUREMENTS ONLY.

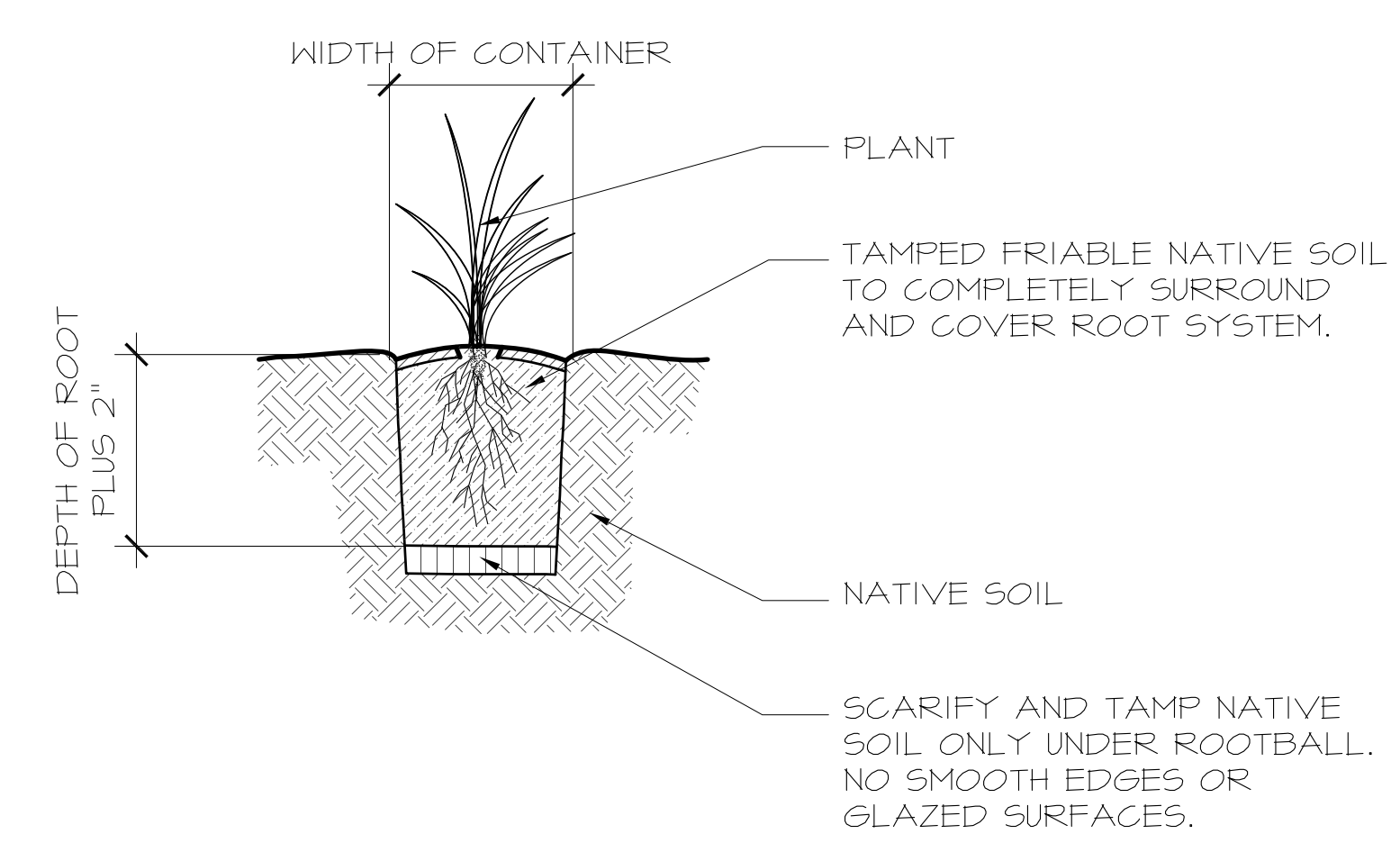

3 PLANTING DETAIL
NTS

4-INCH OR EQUIVALENT CONTAINER SIZE